

# SEAL CATALOGUE

TYPE 1

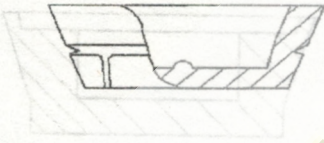

TYPE 2

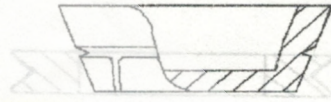

TYPE 3

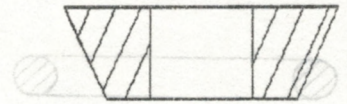

TYPE 4

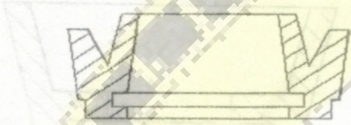

TYPE 5

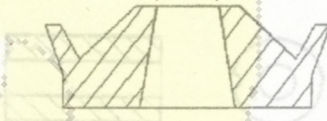

TYPE 6

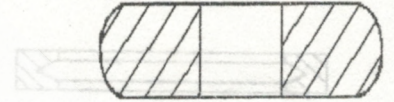

TYPE 7

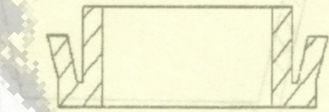

TYPE 8



TYPE 9

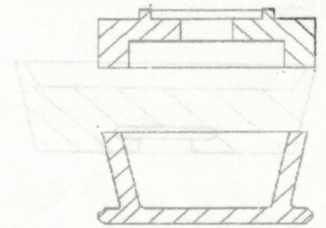

TYPE 10

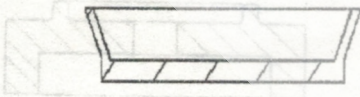

TYPE 11

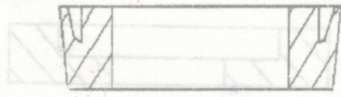

TYPE 12

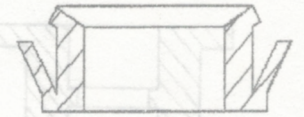

TYPE 13

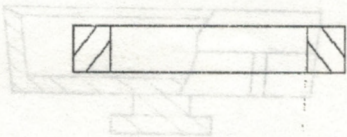

TYPE 14

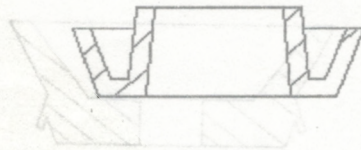

TYPE 15

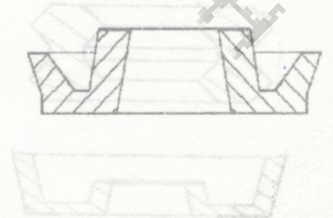

TYPE 16

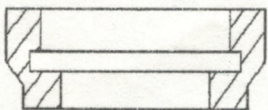

TYPE 17



TYPE 18

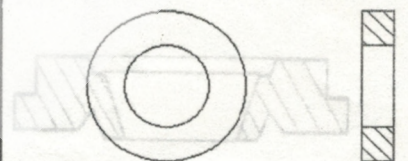



# SEAL CATALOGUE

**TYPE 19**

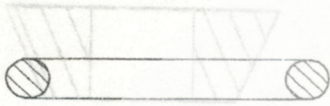

**TYPE 20**

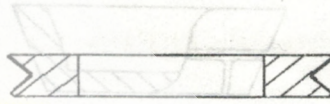

**TYPE 21**

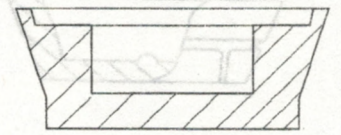

**TYPE 22**



**TYPE 23**

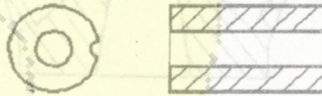

**TYPE 24**

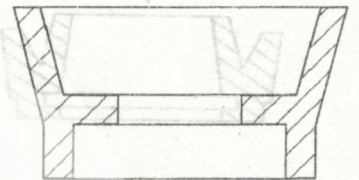

**TYPE 25**

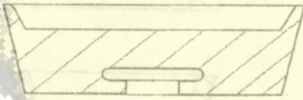

**TYPE 26**



**TYPE 27**

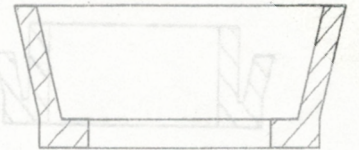

**TYPE 28**

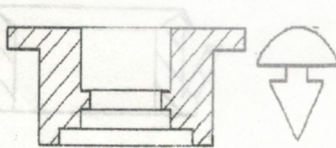

**TYPE 29**

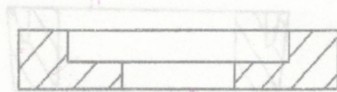

**TYPE 30**

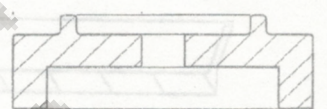

**TYPE 31**

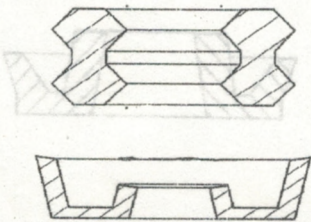

**TYPE 32**

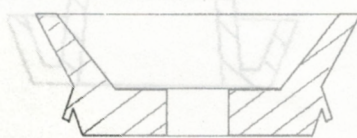

**TYPE 33**

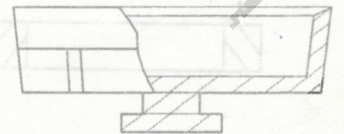

**TYPE 34**

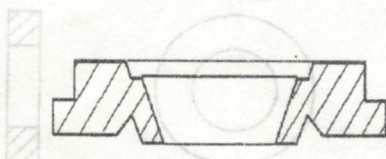

**TYPE 35**

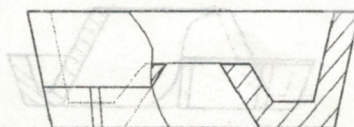

**TYPE 19**

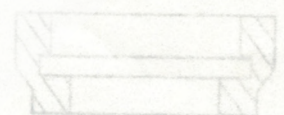



# TYPE 1

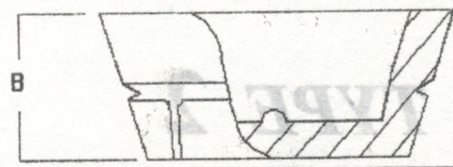

PART No	BORE	B	PART No	BORE	B
7081	17.4	8.9			
7322	17.4	4.4			
7103	19.0	7.1			
7351	19.0	9.1			
7423	19.0	4.4			
7333	20.6	9.0	7247	17.8	7.6
7269	20.6	7.2	7282	19.0	8.0
7328	22.2	9.5	7037	19.0	9.1
7063	22.2	7.9	7271	19.0	7.1
7347	22.2	4.5	7242	20.6	9.2
7048	23.8	7.0			
7085	23.8	9.5			
7075	25.4	9.5			
9240	25.4	7.5			
7173	28.6	9.8			
7348	38.1	11.3	7436	28.6	8.0
7356	44.4	11.3	7040	31.7	11.3
			7152	31.7	10.3
			7364	30.8	11.3

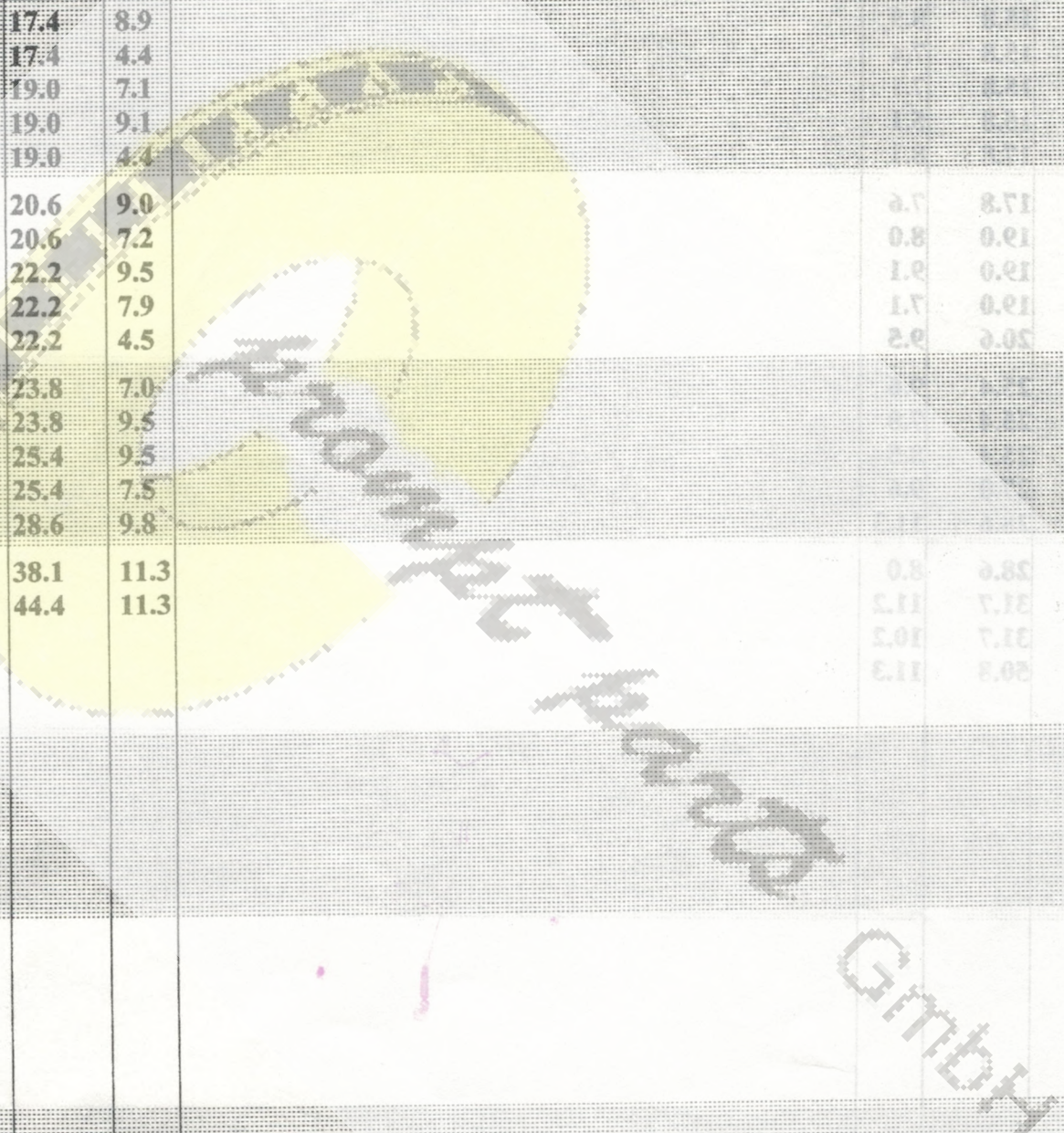



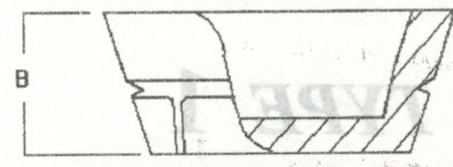

# TYPE 2

PART No	BORE	B	PART No	BORE	B
7111	15.8	8.9			
7301	15.8	7.4			
7747	15.8	7.1			
7702	15.8	5.1			
7179	17.8	8.1			
9247	17.8	7.6			
7585	19.0	8.0			
7037	19.0	9.1			
7271	19.0	7.1			
7245	20.6	9.5			
7032	25.4	9.6			
7263	25.4	7.8			
N9043	25.4	8.5			
7034	27.0	9.6			
7236	28.6	11.3			
7436	28.6	8.0			
7040	31.7	11.2			
7155	31.7	10.2			
7364	50.8	11.3			



Falco  
 GmbH



# TYPE 3

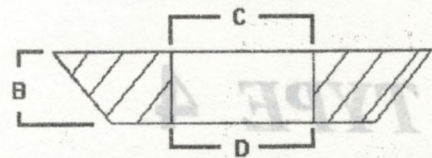

PART No	BORE	C	D	B								
7011	15.8	9.8	9.8	2.5								
7117	17.4	11.8	13.2	2.7								
7051	17.4	10.5	10.5	5.0								
7249	17.4	10.0	10.0	5.0								
7057	17.8	12.3	12.3	2.8								
7043	19.0	11.5	11.5	5.0								
7009	19.0	12.8	12.8	2.8								
7033	20.3	12.1	12.1	5.5								
7129	22.2	14.1	14.4	3.3								
7053	22.2	14.6	14.6	5.1								
7311	22.2	16.4	16.4	2.8								
7723	22.2	16.1	16.1	2.9								
7039	23.8	14.4	14.4	5.5								
7113	25.4	16.3	16.3	5.6								
7131	38.1	28.6	28.6	3.2								
N7262	44.0	34.3	34.3	7.0								

HANSA-TECHNIK  
 GMBH



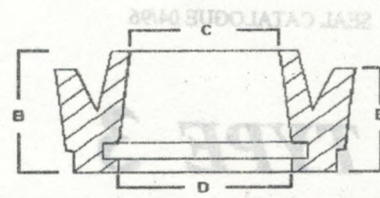

# TYPE 4

PART No	BORE	C	D	B	E
7662	15.8	9.4	9.9	6.6	6.2
7773	17.4	10.6	10.6	8.2	7.7
7630	17.8	11.4	12.8	9.5	7.3
7777	17.8	10.2	10.7	8.2	7.5
7181	19.0	11.4	12.8	9.5	7.7
7035	19.0	12.0	12.8	9.5	7.6
7842	19.0	11.7	10.9	7.7	7.3
7879	19.0	11.4	10.8	7.6	7.2
7010	19.0	11.8	13.2	10.0	7.4
7247	20.6	13.3	14.2	9.5	8.3
7669	20.6	12.9	11.8	7.5	7.3
7978	20.6	11.9	11.9	9.2	7.5
7686	22.2	13.0	13.5	8.1	7.4
7031	22.2	13.2	13.8	9.5	7.3
7464	22.2	14.1	14.5	8.6	7.7
7990	22.2	12.5	13.0	8.0	*
7551	23.8	14.5	15.1	9.8	7.2

Dichtung  
 GmbH



# TYPE 5

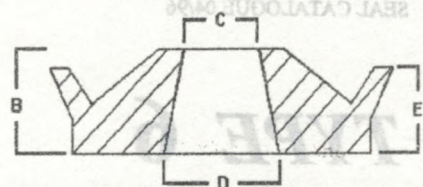

PART No	BORE	C	D	B	E	INFO	B	D	C	BORE	PART No
7210	9.5	4.3	5.0	3.9	3.3						
7214	11.1	5.6	6.2	3.9	3.1						
7383	12.7	5.1	5.7	4.1	3.5						
7385	14.3	5.7	6.6	6.0	5.1						
7939	14.3	6.7	8.6	4.4	3.7						
7015	15.8	6.5	7.6	6.3	5.3						
7859	15.8	7.2	7.6	5.6	4.8						
9421	15.8	6.5	7.6	6.3	5.2						
7125	17.8	7.4	8.5	6.6	5.5						
7055	17.8	7.4	8.5	6.4	5.0						
9402	17.8	7.8	8.6	6.6	*						
7003	19.0	7.5	8.5	6.3	5.1						
7193	19.0	7.5	8.5	6.0	5.0						
7672	19.0	6.8	8.3	6.4	5.0						
7789	19.0	8.8	10.2	6.1	4.6						
7324	19.0	8.8	9.8	5.5	4.7						
7209	20.6	8.8	10.4	6.7	5.4						
7415	20.6	9.4	10.6	6.7	5.9						
7655	20.6	10.1	10.9	6.6	5.0						
7068	20.6	5.9	8.1	7.2	7.1						
7021	22.2	9.9	10.9	7.3	7.1						
7191	22.2	9.8	10.8	6.5	6.5						
7313	22.2	10.7	11.5	6.3	5.4						
7713	22.2	13.6	16.0	4.6	4.2						
7204	22.2	14.4	14.9	5.8	5.7						
7894	22.2	8.5	9.6	7.0	6.7						
7705	23.8	13.0	14.9	5.5	4.8						
7206	23.8	16.3	16.7	6.0	5.7						
7123	25.4	11.7	12.8	6.7	6.0						
7425	25.4	11.3	12.7	6.7	6.1						
7413	28.6	17.8	20.3	7.6	6.8						
7219	28.6	16.2	16.8	6.8	6.4						
7146	28.6	15.2	15.7	8.5	7.1						
7221	31.7	19.4	20.7	6.7	6.2						
7499	31.7	19.3	20.8	6.7	6.4						
9364	33.3	17.1	17.5	8.8	8.6						
9344	33.8	16.7	17.4	8.9	7.9						
7813	34.9	22.4	23.7	6.6	6.1						
7529	38.1	26.0	27.4	6.6	6.0						
7411	38.1	25.8	26.9	6.7	5.9						
7407	41.3	29.3	30.7	6.7	6.1						
7835	44.4	31.9	33.3	6.7	6.0						





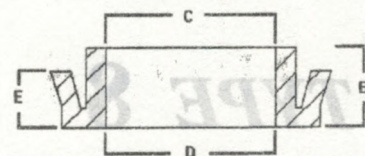

**TYPE 7**

PART No	BORE	C	D	B	E	INFO							
7453	15.8	8.8	8.8	5.7	3.7								
7451	17.8	10.8	10.8	5.8	3.6								
9399	17.8	10.0	11.3	5.5	3.9								
7539	19.0	12.1	12.1	5.6	3.7								
7685	19.0	11.6	12.3	5.7	3.6								
7537	20.6	13.8	13.8	5.7	3.8								
7441	22.2	12.3	12.3	7.3	6.4	groove in heel							
7673	22.2	15.5	15.5	5.7	3.6								
7726	22.2	15.1	15.6	5.7	3.6								
9152	22.2	13.6	13.9	5.7	3.5								
7699	23.8	16.8	17.6	6.0	3.8								
7435	25.4	17.9	17.9	5.9	5.4	groove in heel							
7825	25.4	18.3	19.2	5.8	3.9								
7866	25.4	17.5	17.5	6.2	5.6	groove in heel							
7943	25.4	15.4	15.7	6.8	3.9								
9388	25.4	18.4	18.8	5.7	3.5								
7208	27.0	19.9	20.4	5.7	3.5								
9041	44.8	34.3	35.3	6.7	4.7								

HERZOG  
GmbH



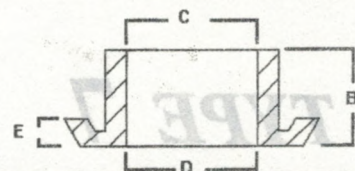

# TYPE 8

PART No	BORE	C	D	B	E	INFO	PART No	BORE	C	D	B	E
7211	25.4	15.8	15.8	8.5	3.3		7237	20.6	13.8	13.8	8.7	3.8
7135	38.1	28.2	28.2	8.5	3.5		7441	22.2	12.3	12.3	7.3	6.4
7195	44.4	34.3	34.3	7.0	3.3		673	22.2	12.5	12.5	8.7	3.6
7487	47.6	37.3	37.3	7.0	4.7		7726	22.2	12.1	12.6	8.7	3.6
							9152	22.2	13.4	13.9	8.7	3.8
						groove in heel						
							9388	22.4	18.4	18.8	8.7	3.2
							7208	27.0	19.9	20.4	8.7	3.2
							9041	44.8	34.3	32.3	6.7	4.7









# TYPE 10



PART No	BORE	B	INFO	INFO	B	D	C	A	PART No
7041	14.3	6.4							
7105	14.3	6.8							
7120	15.8	7.1							
7906	15.8	6.4							
7071	17.4	6.6							
9348	18.3	5.7			4.2	8.0	7.2	10.1	7007
7124	19.0	7.1			4.0	4.8	7.6	11.0	7013
7652	19.0	6.1			4.1	3.8	7.0	11.2	846
7968	19.0	6.4	with pip		4.1	3.2	5.2	11.2	7809
9277	19.0	6.9			4.9	3.4	6.6	11.6	9146
7115	20.6	7.1							
7654	20.6	6.8							
7128	22.2	8.0							
7621	22.2	7.8							
7126	22.2	6.5							
7605	22.2	7.4	raised inner		3.3	4.8	4.8	13.6	7896
7130	23.8	7.9			11.4	6.1	6.1	13.6	7743
7048	23.8	7.0	with pip		12.1			13.7	7901
7748	25.4	7.2			11.7	6.1	6.1	13.8	7911
7132	25.4	7.4			4.1	6.2	6.2	14.7	7801
7160	25.4	6.9							
7134	27.0	7.2							
7325	27.0	5.1							
7735	27.8	7.2							
7136	28.6	7.2							
7136A	28.6	7.5	thick ridge		10.1			18.0	7029
9416	28.6	5.3			8.2	5.2		18.1	7070
9244	28.6	7.8			6.0	1.2	5.1	18.2	7723
7138	30.1	7.2			6.8	7.1	7.1	18.2	7170
7140	31.7	7.2			7.2	4.8	4.8	18.2	7062
7823	31.7	8.5							
7224	31.7	8.5							
7142	33.3	8.1							
7144	34.9	8.1							
7148	38.1	8.2							
7847	38.1	9.1							
7023	41.3	9.6							
7156	44.4	9.5							
7912	47.6	10.3							
7914	47.6	11.1							
7164	50.8	9.4							



# TYPE 11

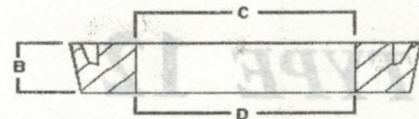

PART No	BORE	C	D	B	E	H	D	C	BORE	PART No
7418	9.5	4.0	4.8	3.3						
7778	14.3	9.1	9.1	3.9						
7581	15.0	9.3	10.0	3.7						
7241	15.8	7.2	8.9	4.8						
7561	17.8	8.4	8.8	3.9						
7227	19.0	11.4	11.4	5.1	3.7	6.0	10.4	10.4	17.8	7276
7443	19.0	7.6	7.6	6.0	3.8	6.6	9.0	9.0	17.8	7264
7651	19.0	10.4	11.7	6.5	3.7	6.7	10.8	10.8	17.8	7278
9357	19.0	6.0	7.5	6.5	3.8	6.6	10.8	10.8	19.0	7092
9418	19.0	10.6	12.0	5.0	4.1	6.2	10.0	10.0	19.0	7633
7393	20.6	12.1	12.1	5.7						
7076	20.6	15.0	15.0	3.9						
7555	20.6	11.2	11.6	4.0						
7653	22.2	15.0	15.0	5.1						
7631	22.2	12.7	13.3	3.8						
9345	22.2	6.0	7.2	6.5	3.9	6.4	11.1	11.1	19.0	9400
9020	23.8	15.3	16.4	3.2	3.7	6.3	11.8	11.8	20.6	7093
7001	25.4	11.7	12.7	7.0	3.6	6.3	11.9	11.9	20.6	7642
7527	25.4	14.8	14.8	5.8	3.7	6.2	13.7	13.7	22.2	7820
7855	25.4	15.0	16.7	5.8	4.1	6.0	13.4	13.4	22.2	7320
7863	25.4	15.1	17.0	5.6						
7471	25.4	13.2	14.1	4.0						
7332	25.4	10.2	12.7	7.6						
9390	28.5	18.3	18.8	5.0						
9271	38.1	15.7	16.5	10.9						
7379	60.3	53.0	55.3	3.0	7.1	9.3	13.5	13.5	27.0	7262
					6.7	8.3	12.7	12.7	27.0	7860
					5.0	7.9	17.8	17.8	27.0	7077
					6.0	9.4	18.2	18.2	30.0	7459
					4.2	7.2	19.2	19.2	30.0	7930
					7.8	11.3	26.9	26.9	38.1	9258
					8.0	11.2	28.0	28.0	41.2	9259
					7.4	10.7	32.2	32.2	44.4	7331
					7.9	11.3	37.0	37.0	50.8	7433



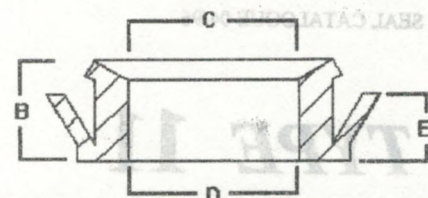

# TYPE 12

PART No	BORE	C	D	B	E
7089	15.8	9.0	9.0	5.3	3.0
7109	17.8	10.2	10.2	6.6	3.2
7182	17.8	10.4	10.4	6.0	3.7
7326	17.8	9.5	9.5	6.9	3.9
7598	17.8	10.1	11.1	5.6	2.8
N7276	17.8	10.4	10.4	6.0	3.7
7264	17.8	9.0	9.0	6.6	3.8
7278	17.8	10.8	10.8	6.7	3.7
7095	19.0	10.8	10.8	6.6	3.8
7633	19.0	10.0	10.0	6.5	4.1
7641	19.0	10.4	10.4	6.5	4.0
7942	19.0	10.0	11.2	6.4	4.2
7950	19.0	11.2	11.2	6.5	4.2
7622	19.0	10.0	10.4	6.5	4.2
7624	19.0	11.3	11.3	6.6	3.8
9400	19.0	11.1	11.1	6.4	3.9
7093	20.6	11.8	11.8	6.2	3.7
7645	20.6	11.9	11.9	6.2	3.6
7820	22.2	13.7	13.7	6.5	3.7
7320	22.2	13.4	13.4	8.0	4.7
7586	22.2	13.4	13.4	6.4	4.2
9047	22.2	9.5	10.1	8.1	5.3
7467	23.8	15.2	15.2	8.5	3.5
7069	25.4	17.0	17.0	7.2	4.7
7477	25.4	15.6	16.4	7.0	
7265	27.0	15.5	15.5	9.3	7.1
7860	27.0	14.8	15.7	8.2	6.7
7077	27.0	17.6	17.6	7.9	5.0
7459	28.6	18.2	18.2	9.4	6.0
7930	28.6	19.5	19.5	7.5	4.5
9408	28.6	17.8	17.8	9.3	4.8
7357	31.7	21.3	21.3	8.0	5.1
9254	34.9	19.0	19.7	10.7	8.0
9360	36.6	18.6	19.7	10.6	8.1
7369	38.1	25.4	25.4	10.5	7.0
9258	38.1	25.6	26.9	11.3	7.8
9259	41.2	28.0	29.2	11.2	8.0
7331	44.4	32.5	32.5	10.7	7.4
7433	50.8	37.9	37.9	11.3	7.9

groove in heel

groove in heel

GETTBY







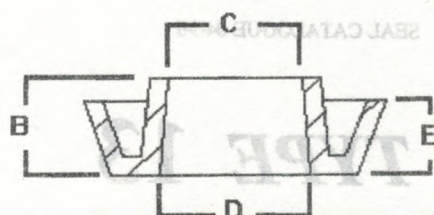

# TYPE 14

PART No	BORE	C	D	B	E	PART No	BORE	C	D	B	E
7188	7.6	5.2	5.2	3.1	2.4	7074	12.7	6.5	7.0	4.0	3.3
9193	28.6	17.0	19.0	4.3	3.8	7059	28.6	18.2	19.5	9.1	8.4
7090	15.8	8.7	10.0	3.3	3.2	7607	28.6	18.0	19.2	9.1	8.3
7050	15.8	7.4	8.2	4.3	4.1	7336	28.6	12.7	14.0	8.1	7.8
7903	15.8	7.6	8.7	6.6	5.8	7427	28.6	13.0	14.0	8.5	7.2
7327	15.8	7.6	8.9	6.6	5.7	7045	31.7	7.0	8.5	6.0	5.3
7788	17.4	9.5	10.2	5.0	4.2	7086	31.7	20.4	22.5	8.8	7.8
7563	17.8	6.9	7.3	4.8	3.8	7342	33.3	13.3	14.5	9.4	7.7
7178	17.8	8.3	9.0	4.7	3.8	9362	38.1	21.6	22.3	10.0	7.6
7876	17.8	9.0	10.0	5.0	3.9	7448	38.1	12.8	14.0	10.2	7.8
7294	17.8	6.6	7.9	5.0	4.0	7261	39.7	12.9	14.5	9.5	7.8
7395	17.8	8.5	9.1	5.6	4.8						
7365	19.0	10.0	11.0	5.5	4.5						
7397	19.0	12.3	12.3	5.1	4.6						
7639	19.0	10.7	11.1	5.5	4.0						
7935	19.0	8.0	8.6	4.9	3.6						
7176	19.0	10.0	10.7	4.9	3.7						
7485	20.6	11.3	11.9	5.0	3.8						
7553	20.6	9.8	10.2	4.8	3.8						
7643	20.6	12.1	12.7	5.3	4.1						
7716	20.6	12.1	12.4	5.3	4.0						
7947	20.6	12.1	12.8	6.0	4.7						
9353	20.6	11.4	11.4	5.3	3.7						
7475	22.2	12.8	13.6	5.3	3.7						
7531	22.2	14.0	14.0	5.1	4.0						
7629	22.2	11.3	11.9	4.9	3.9						
7816	22.2	13.1	13.1	5.1	3.9						
7983	22.2	13.2	13.9	6.0	4.7						
7019	22.2	10.0	10.9	7.0	6.6						
7972	22.2	9.9	10.7	7.0	6.1						
7969	23.8	13.1	14.0	6.1	4.0						
7697	23.8	15.7	15.7	4.1	3.7						
9199	23.8	13.8	15.6	4.3	4.1						
7361	23.8	14.6	15.5	6.5	5.8						
7515	25.4	14.6	17.0	4.5	4.3						
7099	25.4	7.8	8.4	7.9	7.3						
7088	25.4	6.0	7.6	7.3	7.2						
7477	25.4	15.6	16.4	7.0	5.1						
9059	25.4	15.6	17.3	5.0	3.0						
9058	25.4	15.2	16.2	4.8	3.8						
9107	25.4	18.2	19.0	5.5	4.2						
9195	25.4	13.9	15.8	4.3	4.0						
7386	27.0	16.5	18.0	4.8	3.6						



# TYPE 15

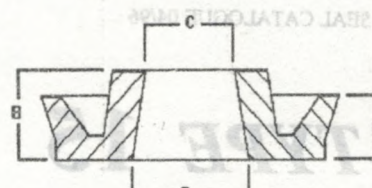

PART No	BORE	C	D	B	E	PART No	BORE	C	D	B	E
7237	7.9	1.8	2.3	4.1	3.5	7929	17.8	8.1	9.0	5.7	4.9
7190	9.0	4.2	4.7	4.0	3.2	7776	17.8	10.8	11.2	4.4	3.1
7239	9.5	4.0	4.3	4.0	3.3	7875	17.8	7.7	8.2	4.7	4.0
9008	10.6	4.2	4.9	4.1	3.3	7956	17.8	8.3	10.8	4.6	4.2
9429	10.6	3.5	4.4	4.1	3.6	7014	17.8	8.3	9.0	6.4	6.4
7087	12.7	4.2	4.8	4.2	3.7	7158	17.8	7.6	8.6	6.0	5.6
7198	12.7	6.0	7.4	4.4	3.8	7298	17.8	10.0	11.0	5.7	5.7
7522	12.7	6.0	6.7	3.9	3.1	7296	17.8	8.0	9.5	4.0	4.0
9167	12.7	2.2	3.0	3.6	3.0	7473	17.8	8.1	8.8	5.3	3.9
7154	14.3	9.6	10.0	3.8	3.5	7781	17.8	10.0	11.4	5.3	4.7
7314	14.3	8.4	8.7	4.3	3.1	9026	17.8	8.2	9.5	6.4	5.8
7646	14.3	6.1	6.8	5.1	4.1	7546	17.8	8.1	9.5	6.0	5.4
7524	14.3	7.5	8.2	4.0	3.1	7552	17.8	10.2	11.2	3.9	2.6
9343	14.3	6.2	6.9	5.0	4.2	7999	19.0	8.6	9.8	6.7	5.2
9406	14.3	7.6	9.2	4.7	*	7810	19.0	9.1	9.6	4.0	4.0
7579	15.0	5.0	6.0	6.4	6.4	7166	19.0	11.8	12.2	4.5	4.1
7560	15.8	9.0	9.7	3.5	2.2	7022	19.0	10.5	11.7	5.0	4.2
9027	15.8	5.8	6.5	7.0	6.5	7982	19.0	10.6	10.6	7.8	7.2
7934	15.8	6.3	7.3	5.0	4.2	7374	19.0	8.8	9.1	5.7	4.7
7908	15.8	9.2	9.5	4.2	3.3	7469	19.0	9.7	10.5	5.1	3.7
7521	15.8	9.3	10.0	5.6	5.0	7772	19.0	9.6	10.4	5.0	3.9
7297	15.8	9.1	9.1	5.1	4.1	7583	19.0	7.9	9.0	6.8	6.2
7479	15.8	8.4	8.8	5.5	4.7	7601	19.0	11.2	12.7	6.0	5.7
7648	15.8	7.0	7.6	5.6	4.5	7644	19.0	9.3	9.9	6.5	5.5
7660	15.8	8.1	9.0	6.6	5.4	7647	19.0	9.1	9.8	6.5	5.0
7668	15.8	6.7	7.7	5.5	4.8	7670	19.0	7.0	8.1	6.4	5.8
7767	15.8	7.0	7.9	5.5	5.0	7674	19.0	7.4	8.1	6.0	5.5
7775	15.8	8.1	9.1	6.5	5.4	7676	19.0	9.1	9.6	6.5	5.2
9387	15.8	8.9	9.7	4.5	3.5	7694	19.0	10.7	11.6	4.6	3.6
9351	16.2	7.4	8.0	4.8	4.0	7708	19.0	8.8	9.7	7.1	5.2
7954	17.4	10.0	10.5	5.5	5.5	7709	19.0	10.2	12.2	4.8	4.3
7180	17.4	8.2	9.0	5.0	3.7	7750	19.0	8.3	8.9	6.8	6.1
7966	17.4	9.4	11.2	5.0	4.0	7765	19.0	8.4	8.8	6.6	5.8
7784	17.4	8.2	9.4	5.0	4.3	7797	19.0	8.0	8.7	6.7	6.7
7786	17.4	8.2	9.2	5.0	4.2	7844	19.0	9.3	10.2	4.4	3.6
7603	17.4	4.3	6.0	6.4	5.8	7857	19.0	8.7	9.4	7.3	5.1
7678	17.4	7.9	8.9	5.8	5.4	7871	19.0	7.0	8.2	6.3	5.7
7704	17.4	8.1	9.1	6.0	4.6	7881	19.0	9.1	9.7	4.1	3.1
7761	17.4	9.4	10.0	5.5	3.8	7905	19.0	7.9	8.8	6.6	6.3
7814	17.4	4.4	5.9	6.7	6.3	7937	19.0	10.8	11.4	6.6	6.6
7953	17.4	9.1	9.6	5.6	4.3	7963	19.0	10.8	11.3	5.8	4.4
7957	17.4	7.7	8.1	6.3	5.7	7977	19.0	9.1	9.8	4.2	3.6
7958	17.8	10.4	11.5	4.7	4.2	7979	19.0	10.4	11.7	5.8	4.8



# TYPE 15

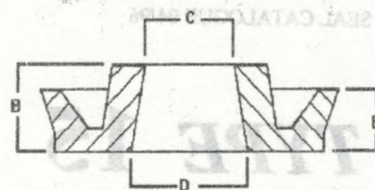

PART No	BORE	C	D	B	E	PART No	BORE	C	D	B	E
7554	19.0	10.3	11.1	3.8	2.8	7684	22.2	11.1	11.8	6.9	5.6
7596	19.0	10.7	11.1	5.0	4.3	7690	22.2	13.2	13.8	5.0	4.0
7594	19.0	10.6	11.6	3.8	2.6	7737	22.2	13.7	15.5	4.6	4.0
N9044	19.0	9.0	11.0	6.0	4.0	7818	22.2	13.0	13.7	5.2	3.8
9342	19.0	10.3	11.1	3.8	2.4	9064	22.2	12.8	13.8	7.0	6.5
9405	19.0	11.1	12.5	5.0	*	9046	22.2	15.2	15.5	4.1	3.4
7711	20.3	11.0	12.8	5.3	4.8	9154	22.2	13.1	13.7	7.9	5.2
7306	20.3	13.6	13.8	4.2	3.4	9207	22.2	13.9	15.9	3.5	3.5
7483	20.6	11.2	11.8	5.1	3.8	9245	22.2	13.2	13.8	5.8	4.6
7533	20.6	10.4	11.1	7.1	5.6	9385	22.2	15.0	15.7	5.4	3.8
7565	20.6	11.5	12.4	6.4	5.4	9386	22.2	13.6	14.1	5.4	3.7
7665	20.6	10.6	10.9	4.5	3.8	9415	22.2	12.9	13.5	6.8	*
7682	20.6	10.3	11.0	7.0	5.4	7346	23.8	14.7	15.7	5.9	4.6
7791	20.6	5.6	7.7	7.2	7.2	7116	23.8	16.1	16.5	5.7	5.7
7812	20.6	8.7	9.9	7.4	7.4	7952	23.8	14.6	15.3	4.9	4.2
7867	20.6	9.8	10.8	6.8	5.5	7082	23.8	12.9	14.6	6.8	5.8
7951	20.6	12.3	13.2	5.8	4.8	7338	23.8	15.5	16.0	7.0	6.4
7266	20.6	10.6	12.4	4.0	3.6	7368	23.8	13.9	14.9	6.3	6.1
7084	20.6	7.5	9.7	5.4	4.8	7549	23.8	13.5	14.5	6.4	6.4
7976	20.6	10.0	11.2	4.4	3.9	7591	23.8	8.1	9.7	7.2	6.9
7996	20.6	12.0	13.8	5.1	3.7	7746	23.8	11.3	12.5	7.7	6.7
7981	20.6	9.6	10.9	6.8	5.4	7758	23.8	14.3	15.2	5.1	4.1
7574	20.6	13.3	14.3	4.0	3.0	7760	23.8	14.4	15.2	5.1	3.7
7582	20.6	10.8	11.2	4.2	3.2	7967	23.8	12.2	12.9	7.2	5.1
7590	20.6	12.0	12.8	4.0	2.5	7995	23.8	13.8	15.0	7.2	5.1
9218	20.6	12.6	14.4	3.9	3.5	9063	23.8	15.6	15.6	7.2	5.8
9033	20.6	10.9	11.5	5.1	3.9	9203	23.8	15.8	17.5	3.5	3.5
9337	20.6	12.9	13.5	5.5	4.8	9284	23.8	17.0	17.5	4.8	4.0
9404	20.6	11.2	12.4	5.4	*	N9324	23.8	16.6	18.1	7.0	5.3
9414	20.6	10.1	11.4	5.6	*	9349	23.8	13.4	15.0	7.0	6.0
9423	20.6	9.0	9.5	4.8	3.9	7758	23.8	14.3	15.2	5.1	3.9
7186	22.2	12.6	13.0	6.3	6.3	9380	23.8	9.1	9.7	7.7	6.6
7986	22.2	12.0	13.1	5.0	4.2	9403	23.8	13.9	15.3	5.6	*
7073	22.2	14.0	14.0	5.8	5.0	9422	23.8	12.2	13.0	4.8	3.9
7070	22.2	13.2	13.8	6.0	5.0	7232	25.4	15.0	16.5	5.8	5.2
7250	22.2	13.0	13.5	7.9	5.7	7355	25.4	15.7	16.3	6.8	6.3
7390	22.2	12.9	13.4	5.6	4.9	7017	25.4	11.7	13.1	7.2	7.2
7304	22.2	12.6	13.3	5.2	3.8	7525	25.4	14.5	15.6	4.6	4.0
7005	22.2	9.3	11.2	7.0	7.0	7543	25.4	13.7	15.2	8.4	7.8
7101	22.2	8.5	10.2	6.0	5.8	7569	25.4	16.8	17.9	5.1	4.7
7349	22.2	13.2	14.0	5.8	4.6	7828	25.4	16.0	16.9	6.7	5.0
7597	22.2	13.6	15.5	6.7	5.9	7830	25.4	16.4	17.0	6.6	4.6
7680	22.2	9.8	10.8	7.0	6.1						



# TYPE 15

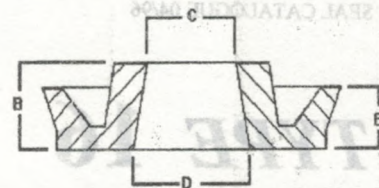

PART No	BORE	C	D	B	E	PART No	BORE	C	D	B	E
7118	25.4	13.0	13.9	8.0	7.1	7225	42.8	30.7	32.1	9.0	8.4
7310	25.4	17.9	19.0	3.7	3.2	9048	42.8	27.0	28.4	11.2	7.8
7593	25.4	14.9	15.7	5.9	4.7	9377	42.8	26.9	28.5	11.1	7.6
9053	25.4	18.2	18.8	4.1	4.1	7151	44.4	33.9	35.1	6.3	6.3
7802	25.4	14.2	16.1	6.6	5.8	7375	44.4	34.6	34.6	7.1	4.9
9054	25.4	12.7	14.2	7.0	5.7	9052	44.4	28.4	29.1	8.1	6.9
9159	25.4	13.0	13.6	8.0	7.0	7133	50.8	37.5	38.7	7.9	7.9
9391	25.4	15.7	16.5	4.7	3.7	N9397	54.6	34.4	35.7	9.5	7.8
9206	27.0	15.3	17.2	4.7	4.1	N9379	54.0	34.2	35.7	9.5	7.9
9216	27.0	19.4	21.4	3.5	3.2	7149	57.1	43.6	45.7	7.9	7.9
9246	27.0	16.4	18.1	4.4	3.6						
7403	27.0	15.9	17.8	5.5	4.8						
7102	27.0	16.0	18.2	3.7	3.7						
7036	28.6	18.8	19.8	5.6	5.6						
7091	28.6	18.9	22.2	8.8	7.2						
7378	28.6	12.1	13.4	9.0	6.8						
9381	28.6	12.2	13.2	8.9	6.8						
N9193	28.6	16.7	17.1	4.9	4.3						
7049	30.1	12.1	13.5	8.4	7.8						
7329	30.1	19.9	21.3	8.1	7.5						
7122	30.1	12.0	13.4	8.4	6.8						
7234	30.1	18.5	20.0	6.2	6.2						
9395	30.1	15.8	17.2	6.6	4.8						
7119	31.7	19.7	22.5	7.5	7.1						
7147	31.7	22.6	22.6	9.1	8.0						
7613	31.7	20.3	21.8	8.7	8.3						
7367	31.7	20.7	21.9	8.1	7.3						
7513	31.7	20.9	21.9	5.1	4.4						
7104	31.7	20.2	22.4	8.7	8.3						
9344	33.3	16.6	17.4	9.0	8.0						
9363	33.3	18.3	19.7	9.5	8.0						
7027	34.9	24.5	26.4	6.2	6.2						
7359	34.9	23.0	24.8	7.7	7.0						
7096	34.9	24.0	26.0	8.0	7.4						
9050	34.9	22.8	23.1	9.6	6.4						
7223	38.1	27.8	27.8	8.4	7.5						
7291	38.1	26.0	26.8	8.8	7.9						
9049	38.1	23.6	24.7	10.0	7.6						
9051	38.1	23.8	24.9	8.1	7.0						
7627	41.3	29.2	31.4	9.1	8.2						
9255	41.3	25.8	27.7	7.7	7.2						
9257	41.3	26.9	28.0	9.0	7.8						
7235	42.8	30.5	32.3	9.4	8.6						



# TYPE 16

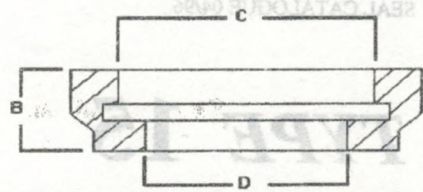

PART No	BORE	C	D	B
7020	15.8	9.9	7.7	6.8
7107	15.8	13.3	8.8	8.0
7319	15.8	12.2	10.3	6.2
7745	15.8	12.7	10.5	5.5
7589	15.8	12.7	11.2	5.8
7777	15.8	10.7	10.3	5.7
7861	15.8	12.7	10.7	5.6
7909	15.8	12.7	11.1	5.7
7097	17.4	14.7	11.0	7.6
7024	19.0	13.5	10.8	6.7
7065	19.0	15.7	12.0	7.4
7481	19.0	14.2	11.7	7.4
7763	19.0	13.2	11.9	6.6
7587	19.0	14.7	11.0	8.1
7795	19.0	16.0	13.0	4.1
7901	19.0	14.7	11.9	6.6
7335	20.6	17.2	13.1	6.6
7793	20.6	16.5	13.0	4.1
7971	20.6	16.9	13.1	4.0
7061	22.2	17.9	13.8	8.1
7528	22.2	17.8	13.3	7.1
7744	22.2	16.8	11.4	7.2
7127	23.8	20.3	15.5	7.1
7025	25.4	21.0	15.2	7.0
7079	25.4	21.1	15.5	7.6
7532	25.4	20.8	14.4	8.9
7870	25.4	20.3	14.2	7.5
7083	27.0	23.1	14.4	7.2
7153	27.0	21.5	16.2	7.2
7157	28.6	22.5	16.8	7.3
7175	28.6	24.4	16.6	7.9
7293	31.7	26.9	20.6	7.1
7540	31.7	27.0	20.8	7.1
7137	38.1	32.1	27.8	6.9
7171	38.1	33.5	24.0	9.5
7548	38.1	30.4	25.0	8.0
N9412	38.1	33.0	24.5	7.4
7556	44.4	39.0	31.8	8.2
7564	50.8	46.2	39.2	7.9



# TYPE 17

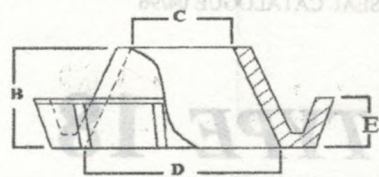

PART No	BORE	C	D	B	E	PART No	BORE	C	D	B	E	PART No
7457	16.5	7.3	7.7	5.0	3.7	9246	25.4	13.1	14.0	4.5	3.9	
7960	17.4	8.3	9.3	4.7	4.0	7826	25.4	15.0	16.1	5.2	4.0	
7771	17.4	5.5	6.0	5.5	5.0	7463	27.0	7.6	8.5	9.6	9.5	
7877	17.4	7.4	7.8	5.4	3.3	9175	27.0	16.6	18.3	4.9	3.9	
7955	17.4	8.3	9.1	5.1	3.9	9189	27.0	7.7	10.6	3.8	3.5	
7461	17.8	8.4	9.0	5.1	4.2	9192	27.0	8.0	10.1	3.9	3.5	
7779	17.8	6.6	7.9	5.2	5.2	9067	28.6	9.3	9.9	7.0	5.8	
7242	19.0	9.5	10.4	5.2	5.6	9178	28.6	13.3	14.2	4.4	3.8	
7696	19.0	8.3	8.9	4.5	3.9	9186	28.6	16.9	18.6	4.1	3.2	
7751	19.0	8.6	9.1	4.5	3.7	9409	28.6	19.0	19.6	5.0	4.2	
7840	19.0	7.0	8.0	4.6	3.5	9188	30.1	13.6	14.5	5.7	4.8	
7959	19.0	9.5	10.4	5.8	5.2	7440	31.7	10.4	11.0	9.5	9.5	
7975	19.0	7.1	7.9	4.5	3.5	7240	31.7	13.2	14.4	8.8	8.8	
7401	19.0	6.8	8.1	6.1	5.5	7511	31.7	16.6	17.3	5.1	4.2	
7489	19.0	10.4	11.2	5.0	4.0	7440	31.7	10.2	11.2	9.4	9.4	
7567	20.6	7.1	8.0	7.0	6.4	9184	31.7	16.7	18.2	5.5	4.5	
7667	20.6	8.2	8.7	5.1	3.9	9394	34.2	14.2	21.6	8.3	8.3	I/S
7949	20.6	9.7	10.4	5.0	4.0	Step						
7974	20.6	10.5	12.0	4.6	3.6	9191	34.2	18.0	19.4	5.7	4.7	
7998	20.6	10.6	11.8	4.6	3.6	7248	38.1	16.3	17.0	11.4	11.4	
9185	20.6	11.4	12.9	5.0	3.8	7256	44.4	9.8	11.0	11.2	11.2	
7571	22.2	9.9	11.5	6.5	5.3							
7692	22.2	8.2	9.0	4.6	3.9							
7985	22.2	10.2	11.2	6.3	5.1							
7535	22.2	13.1	14.2	4.8	4.0							
7006	22.2	10.1	11.1	5.7	3.8							
7988	22.2	12.0	13.1	5.1	4.5							
9153	22.2	10.5	11.7	5.6	3.7							
9183	22.2	9.4	11.9	5.3	3.8							
9187	22.2	10.4	11.9	4.0	3.3							
9384	22.2	13.1	13.8	5.1	4.6							
7547	23.8	11.9	13.0	4.9	4.9							
7965	23.8	12.2	13.1	5.1	4.0							
7465	23.8	13.7	14.5	5.7	3.9							
7268	23.8	14.2	14.8	4.9	4.2							
9417	23.8	9.5	10.2	5.0	3.5							
9176	23.8	9.4	12.2	4.8	4.1							
9190	23.8	11.3	13.4	3.9	3.2							
9006	23.8	12.7	12.7	4.1	3.8							
7445	25.4	16.6	16.6	5.0	4.6							
7509	25.4	15.0	16.3	4.7	3.7							
9172	25.4	9.5	11.7	4.9	4.0							
9174	25.4	15.9	17.1	4.8	4.0							



# TYPE 18

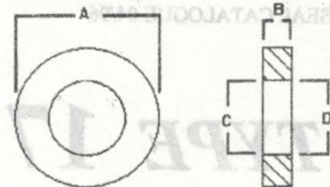

PART No	A	C	D	B		PART No	A	C	D	B	
9113	10.0	6.0	6.0	2.0		7902	25.8	19.3	19.3	5.8	
9250	11.4	6.8	6.8	4.6		9383	25.9	29.0	29.0	11.2	
7727	12.2	7.9	7.9	3.2		7787	26.0	18.8	18.8	6.0	
7428	12.4	7.9	7.9	1.9		7941	26.8	17.6	17.6	6.6	Nylon
9028	12.5	8.0	8.0	2.2		7764	27.7	17.1	17.1	3.2	Nylon
7002	14.0	9.3	9.3	1.8		7895	28.0	24.0	24.0	3.1	
7845	14.3	10.2	10.2	3.7		7199	29.4	8.5	8.5	2.9	
7915	15.4	9.8	9.8	0.8		7143	30.1	17.5	17.5	4.8	
7796	15.8	8.9	8.9	3.7		7803	31.4	27.7	27.7	5.0	
7851	15.9	12.2	12.2	3.8		7731	31.6	20.5	20.5	3.1	
7904	16.5	9.5	9.5	3.2		7412	32.0	26.9	26.9	1.7	
7997	17.0	13.1	13.1	2.3		7819	32.8	22.9	22.9	2.4	
7918	17.1	13.2	13.2	1.9		7815	33.0	23.0	23.0	2.4	
7907	18.8	7.3	7.3	3.2	Notched	7916	33.0	30.0	30.0	17.5	
9060	18.9	10.5	10.5	3.5		7161	34.9	18.0	18.0	4.7	
7167	19.0	9.8	9.8	3.0		7315	38.1	20.3	20.3	3.0	
7231	19.0	6.8	6.8	2.5		9062	38.1	27.0	27.0	2.0	
7233	19.0	9.5	9.5	4.7		7577	40.0	21.5	21.5	3.2	
7207	19.0	12.6	12.6	2.9		7940	41.3	30.5	30.5	2.5	
7893	19.7	13.6	13.6	3.3		7275	41.3	24.1	24.1	3.4	
7794	20.0	16.8	16.8	1.6		7719	42.8	26.9	26.9	3.2	
7409	20.3	11.3	11.3	4.8		9268	44.3	33.4	33.4	2.5	
7212	20.6	13.8	13.8	2.3		7725	44.6	24.9	24.9	2.3	
7139	20.6	12.9	12.9	3.2		7575	44.9	26.9	26.9	3.2	
7807	21.2	12.7	12.7	3.3	Sided	7717	47.8	30.0	30.0	2.9	
9003	21.9	12.2	12.2	4.8		7259	50.8	39.6	39.6	3.2	
7886	22.0	12.4	12.4	5.0		7689	51.7	36.4	36.4	3.0	
7243	22.2	16.2	16.2	1.6		7938	53.5	45.6	45.6	2.5	
9002	22.2	12.7	12.7	5.0		7922	53.9	46.5	46.5	2.6	
7932	23.0	17.9	17.9	3.0		7279	54.0	35.9	35.9	3.4	
7288	23.1	19.3	19.3	3.3		9159	54.2	36.6	36.6	3.1	
9061	23.1	13.3	13.3	6.0		7391	56.3	38.9	38.9	3.0	
7197	23.8	7.6	7.6	2.2		7273	57.1	39.1	39.1	3.3	
9016	23.8	18.8	18.8	4.1		7277	57.1	39.6	39.6	3.2	
7756	24.5	11.3	11.3	0.8	Nylon	7900	59.9	56.1	56.1	2.9	
7880	24.7	14.2	14.2	3.2	Nylon	7811	63.1	43.2	43.2	2.7	
7677	24.8	18.5	18.5	3.7		7785	74.6	55.5	55.5	2.2	
9238	25.0	7.5	7.5	2.5		7883	79.0	61.7	61.7	3.0	
7790	25.3	19.2	19.2	3.0	Nylon	7706	86.6	67.4	67.4	2.8	
7159	25.4	12.9	12.9	4.8		7841	92.0	70.4	70.4	2.4	
7163	25.4	13.0	13.0	4.8	Hex inner						
7891	25.4	13.2	13.2	6.0							
7898	25.4	12.8	12.8	4.8							



# TYPE 19

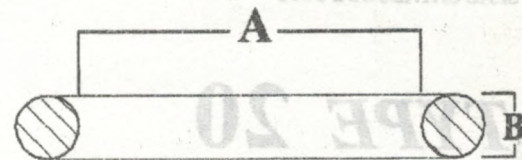

PART No	A	B	PART No	A	B	PART No	A	B
7072	2.1	2.0	7308	19.0	2.0			
7736	4.1	1.5	9114	19.0	2.5			
7873	4.3	1.9	9227	19.8	3.6			
7899	4.3	1.7	9231	19.9	3.5			
7317	4.7	1.8	9221	20.0	3.5			
7666	4.7	2.0	7558	20.0	2.0			
7752	4.8	1.7	7710	20.2	3.6			
7600	5.0	2.0	9165	20.4	2.0			
7920	5.5	1.7	9168	20.4	1.8			
7416	6.0	2.0	9115	20.5	2.6			
7646	6.1	1.8	9068	21.8	3.5			
7424	6.2	1.2	7341	21.9	2.5			
7046	6.3	1.7	9219	22.0	3.5			
7792	6.9	2.0	9117	22.6	3.5			
9001	7.0	2.0	9065	23.4	3.5			
7843	7.6	1.7	9118	24.0	2.0			
7722	9.2	2.6	7270	24.3	3.0			
9164	9.2	1.9	9226	24.4	3.6			
7849	9.3	1.9	9166	24.8	3.5			
7562	10.8	2.6	9066	25.0	3.5			
9411	10.8	1.8	7414	25.0	2.5			
7426	11.0	2.2	9056	25.5	3.5			
9243	11.0	2.4	7447	25.8	3.5			
9029	11.6	2.3	7739	26.0	2.5			
7344	11.9	1.9	7865	29.0	3.0			
7718	12.2	2.4	7626	30.0	2.0			
7919	12.3	1.6	9398	31.5	1.8			
7921	12.3	2.4	9019	33.0	2.5			
9276	12.4	2.6	9023	39.0	3.0			
7923	13.6	1.9	7724	40.9	3.5			
7246	13.6	2.5	7759	40.9	2.7			
7887	13.8	2.5	7944	42.0	2.5			
9143	15.0	2.0	7928	42.4	2.5			
9223	15.0	3.5	7804	54.6	3.5			
7343	15.7	2.5						
7216	16.2	2.5						
9224	16.5	3.5						
9229	16.9	3.5						
7741	17.1	2.5						
7806	17.3	1.8						
9116	17.7	3.5						
9220	18.4	3.5						
7693	18.5	1.8						







# TYPE 21

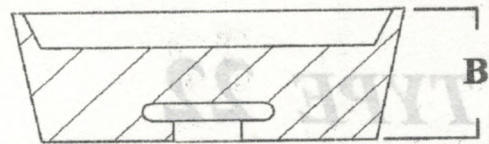

PART No	BORE	B	B	C	A	PART No
7345	19.0	8.1				
7363	22.2	8.1				
7431	25.4	7.9				
7768	25.4	17.4				
7770	25.4	7.5				
7493	28.6	14.5	25.2	1.64	52.7	7381
7495	28.6	7.9	24.2	4.7	53.2	7438
7740	31.7	7.6	28.3	4.87	56.0	7309
7337	38.1	11.0	33.9	5.4	58.5	7381
			41.1	5.1	59.3	7182

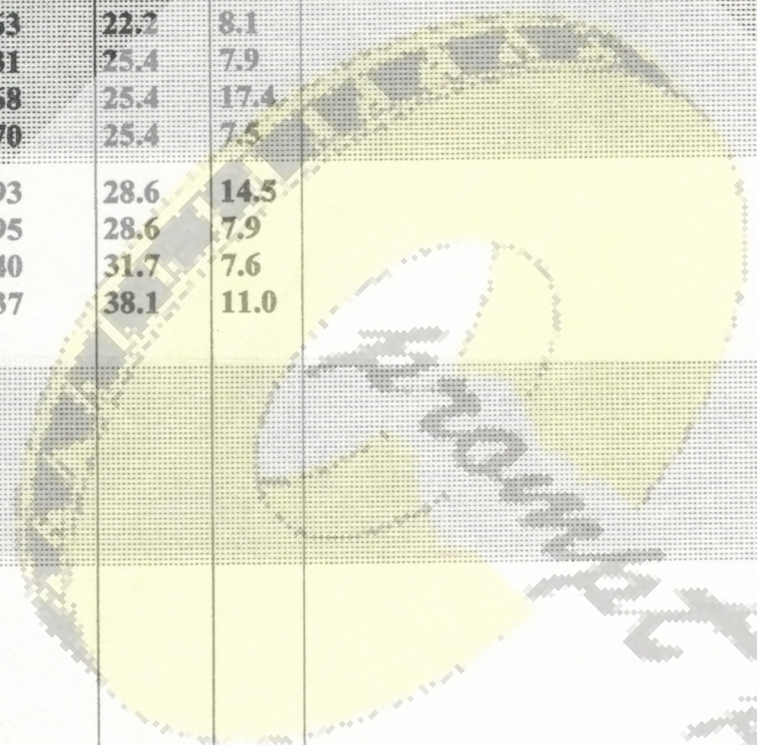

F. MANNING  
 GmbH



# TYPE 22

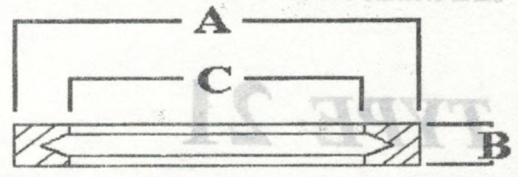

PART No	A	C	B
7659	21.0	15.5	3.4
7108	42.5	36.7	2.6
7800	44.8	39.2	2.5
N7550	47.8	41.7	3.0
7285	47.9	42.2	3.3
7281	52.7	43.1	2.5
7438	53.2	47.7	2.4
7309	56.0	48.7	3.9
7381	58.5	51.4	3.9
7185	59.3	51.1	4.1
7257	62.5	55.1	3.7
7599	64.0	56.8	3.6

Dichtungstechnik  
 GmbH



# TYPE 23

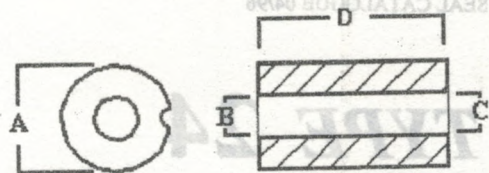

PART No	A	B	C	D	PART No	BORE	B	C	D
018	8.5	3.0	5.2	5.4					
742	10.0	6.7	6.7	7.6					
503	12.2	6.5	6.5	7.1					
323	12.3	6.8	6.8	6.8					





# TYPE 24

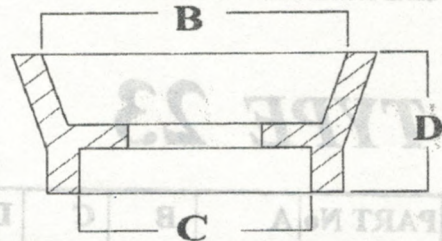

PART No	BORE	B	C	D
---------	------	---	---	---

7299	19.0	11.2	12.4	10.0
------	------	------	------	------



P. 1000  
 GmbH



# TYPE 25

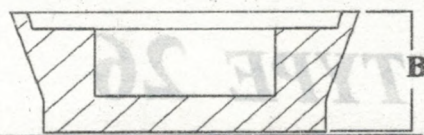

PART No	BORE	B	D	C	B	PART No	BORE	B
---------	------	---	---	---	---	---------	------	---

7169	22.2	5.3						
------	------	-----	--	--	--	--	--	--

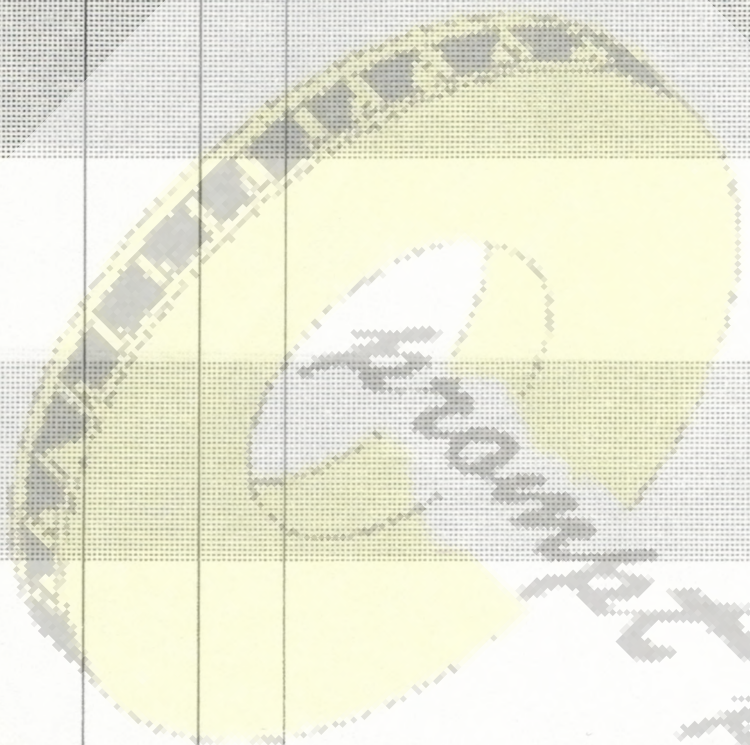

GmbH



# TYPE 26

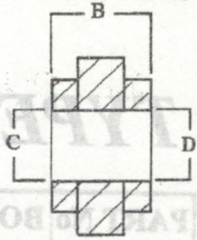
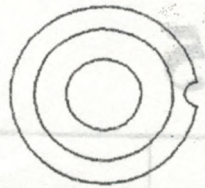

PART No	BORE	B	C	D
---------	------	---	---	---

7141	25.4	12.7	12.7	4.8
------	------	------	------	-----



FRANZ  
GmbH



# TYPE 27

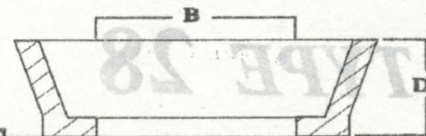

PART No	BORE	B	C	D
9356	8.4	2.0	4.1	4.9
7449	13.0	5.0	5.0	5.8
9382	13.2	5.2	10.2	5.5
9359	13.5	4.4	8.4	4.9
9389	14.3	4.7	10.3	5.0
9358	16.2	3.1	9.2	5.2
9355	18.6	3.0	10.5	5.5
7230	19.0	11.0	11.0	6.5
7078	22.2	18.2	9.0	5.0
7517	31.7	19.3	19.3	8.0

HANNOVER  
 Pneu-Druck  
 GmbH



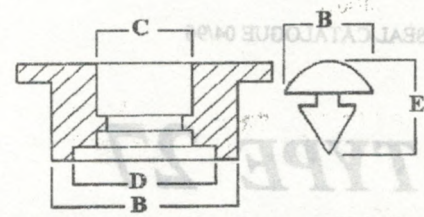

# TYPE 28

PART No	B	C	D	E
7913	7.1			6.6
7671	9.1	5.1		12.8
7260	11.0			6.7
7634	11.0			4.2
7755	12.7	4.9		9.6
7743	13.6	6.1	6.1	11.4
7172	17.3	7.7	7.7	17.7
7675	20.0	7.0	9.5	7.9
7701	20.0	10.8	10.8	9.9
7754	20.1	9.2	10.4	16.1
7637	20.1	8.9	10.6	16.0
7545	20.3	8.5	8.5	7.4
7695	20.3	9.0	9.0	16.1
7026	21.4	9.7	9.7	7.7
7572	21.4	14.0	14.0	9.1
7808	21.8	12.2	14.5	15.0
7730	22.6	12.2	14.5	17.4
7580	22.8	12.1	16.1	12.2

Greiner GmbH



# TYPE 29

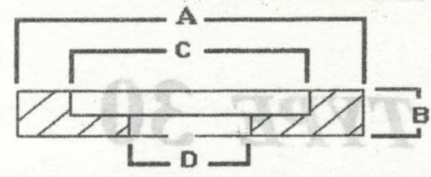

PART No	A	C	D	B						
7505	11.8	3.0	3.0	2.7						
7657	20.0	16.0	12.4	3.2						
7663	21.2	18.0	16.0	2.9						
7642	21.2	18.0	16.1	3.2						
9004	22.2	17.8	15.3	4.0						
7394	41.2	9.0	11.6	4.2	5.2	8.2	8.2	18.7	7.81	7687
					10.2	6.7	6.7	22.2		7931

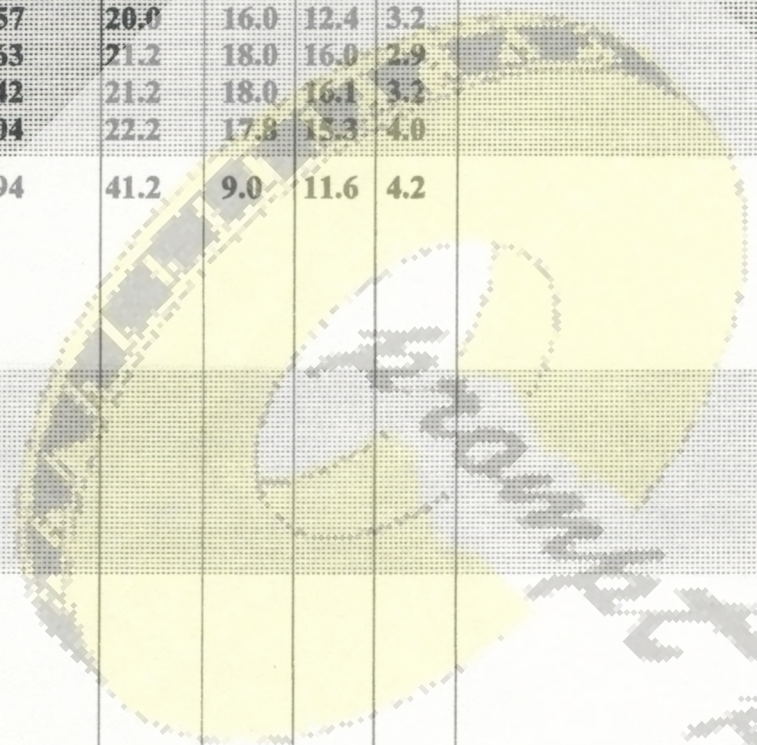

Pneu-Technik  
 GmbH



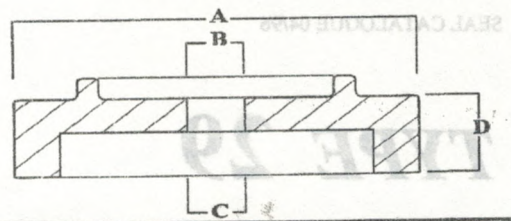

# TYPE 30

PART No	A	B	C	D
7864	14.7	4.7	4.7	8.5
7635	16.0	5.9	5.9	5.5
7889	17.0	3.6	3.6	3.1
7749	18.2	4.8	4.8	5.8
7753	18.3	5.2	5.2	5.5
7687	18.7	5.8	5.8	5.3
7931	22.2	6.7	6.7	10.2





# TYPE 31

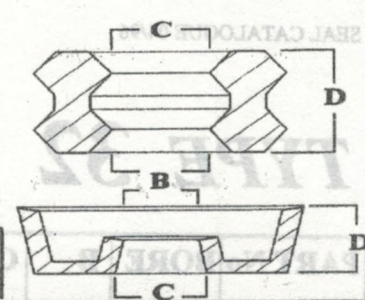

PART No	BORE	B	C	D	INFO	D
7098	15.8	12.9	5.1	3.8		
7362	17.8	8.8	8.8	3.4		
9202	19.0	11.2	13.2	3.5		
9211	19.0	11.1	13.2	3.4		
7987	22.2	13.2	13.2	5.8		
7008	22.2	13.8	13.8	4.8		
9209	22.2	14.6	16.1	3.3		
9213	22.2	15.0	16.2	3.5		
7757	25.4	13.1	13.1	10.3		
7783	25.4	14.4	14.8	7.6		
7878	25.4	12.1	13.9	3.7		
7578	25.4	13.2	15.1	6.1		
9144	27.8	16.5	17.8	6.0		
9352	27.8	16.6	17.6	6.3		
7762	28.6	15.9	17.3	4.1		
7615	28.6	17.5	17.5	3.8		
9017	28.6	16.5	16.5	10.5		
7302	28.6	15.7	17.8	6.5		
9055	31.7	18.6	20.2	6.2		
7588	34.5	15.6	17.8	7.3		
9032	37.9	24.1	26.0	8.3		

DR. H. C. W. GMBH



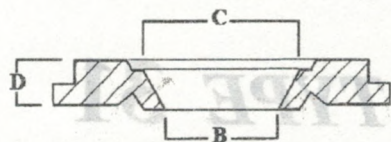

# TYPE 32

PART No	BORE	B	C	D	INFO
7421	38.1	16.1	17.8	4.7	
7766	38.7	9.4	9.4	4.5	
7703	41.8	7.6	7.6	4.3	metal plate
7839	65.7	14.7	14.7	4.0	

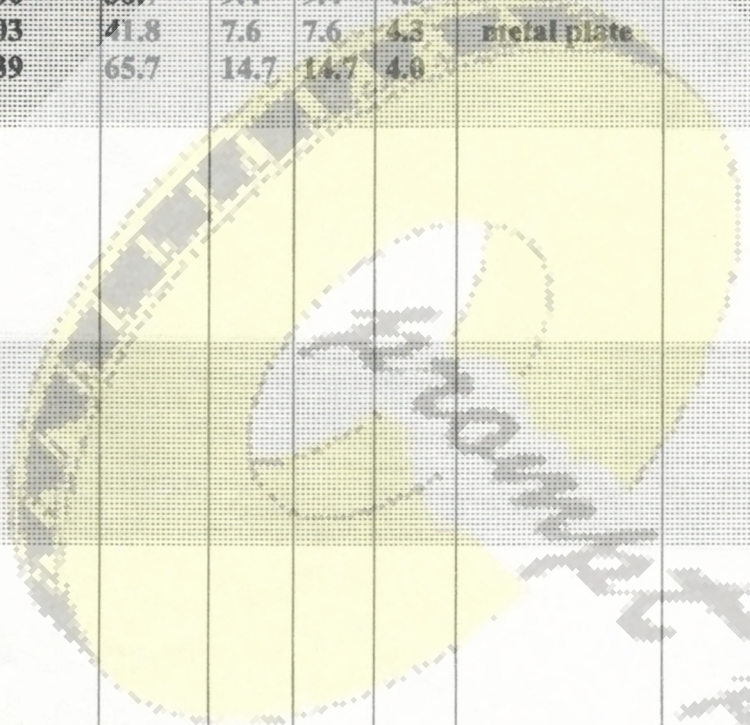

HERZBERG  
GmbH



# TYPE 33

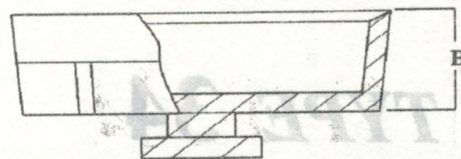

PART No	BORE	B	D	C	B	PART No	BORE	B
7501	17.4	8.7						
7491	19.0	8.8						
7497	20.6	8.9						
7177	31.7	8.0						
			20.6	19.7	19.7	31.7		

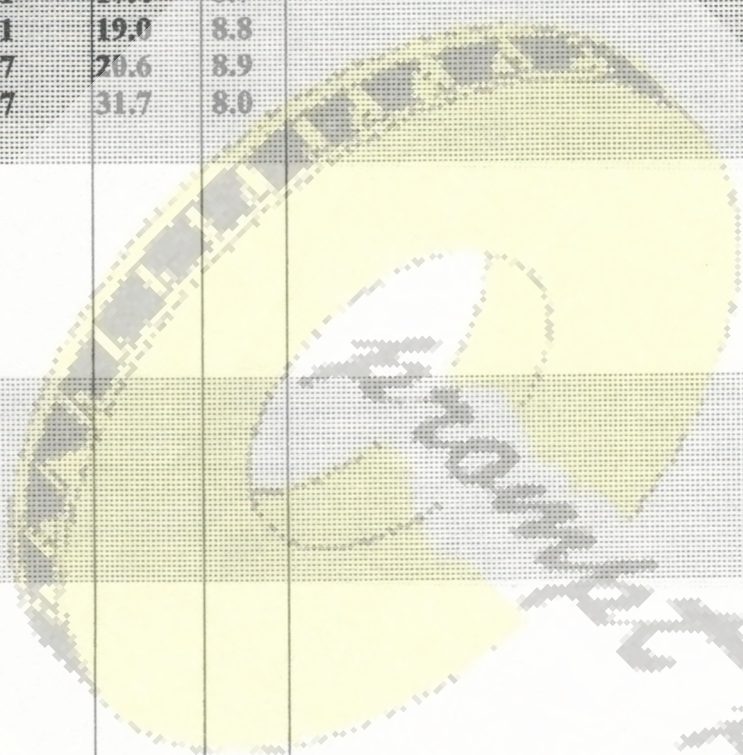

FRIEDRICH  
WALD  
GmbH



# TYPE 34

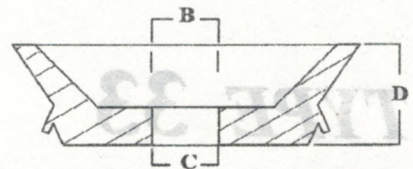

PART No	BORE	B	C	D
9198	23.8	14.4	14.4	5.0
9194	25.4	13.8	13.8	5.0
9197	25.4	14.8	14.8	5.0
9205	27.0	15.8	15.8	5.3
9201	28.6	17.0	17.0	5.0
9204	31.7	19.7	19.7	6.0



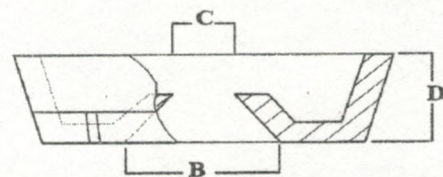

**TYPE 35**

PART No	BORE	B	C	D
9179	19.0	10.6	7.7	3.8
7576	20.6	8.8	7.1	3.6
9177	22.2	10.6	7.7	3.8
9180	23.8	10.6	7.7	3.8
7507	25.4	8.0	10.4	3.7
9173	25.4	10.0	7.7	3.6
7455	28.6	10.2	11.0	10.4
9171	28.6	10.0	7.7	3.8
9181	31.7	13.2	11.1	3.8